

Franklyn James



Shipbuilding Way

, London, E13 9GG

£350,000

A beautifully presented one-bedroom apartment at 16 Shipbuilding Way, London E13, offered at £350,000. This fully furnished home features a sleek modern interior, double glazing for added comfort, and a private balcony with impressive skyline views.

Residents also benefit from concierge service, a fully equipped gym, and a swimming pool.

Ideally positioned near Canning Town, the property offers excellent connectivity via Canning Town Station and Custom House DLR Station. You're also moments from ExCeL London, alongside a wide range of shops, restaurants, and local amenities.

An ideal choice for first-time buyers or investors seeking a modern home in a well-connected and fast-growing area. Arrange a viewing today.

- Private balcony with skyline views
- Concierge service
- Excellent transport links
- Residents' gym
- Ideal investment or first-time purchase

Viewing

Please contact our Limehouse Sales Office on 02077911777 if you wish to arrange a viewing appointment for this property or require further information.

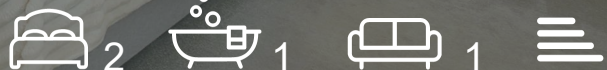

Floor Plan

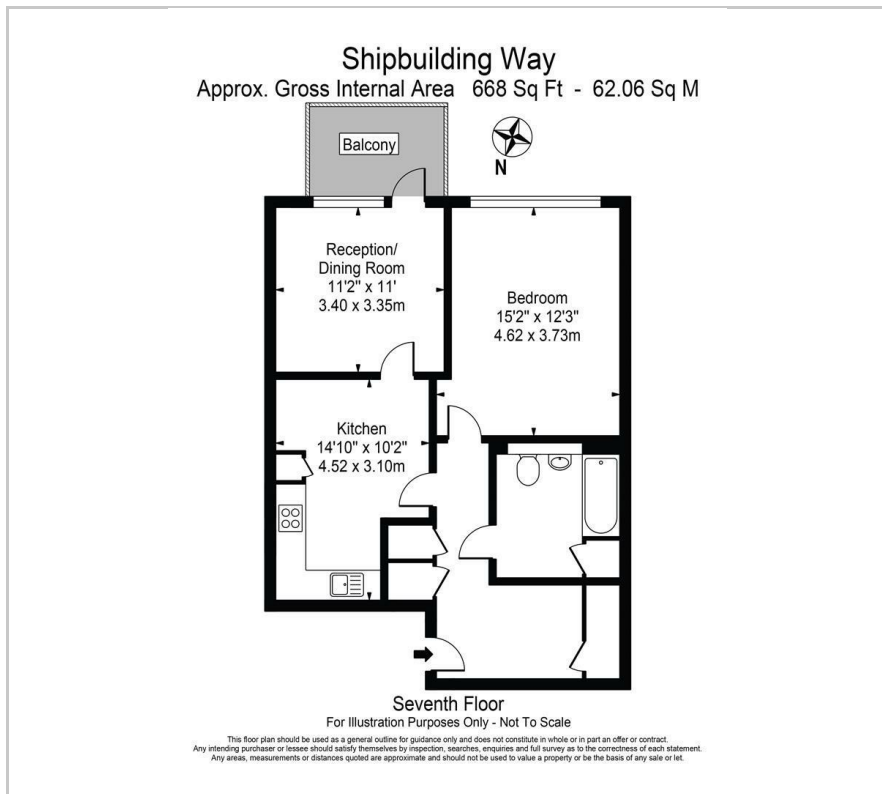

Area Map

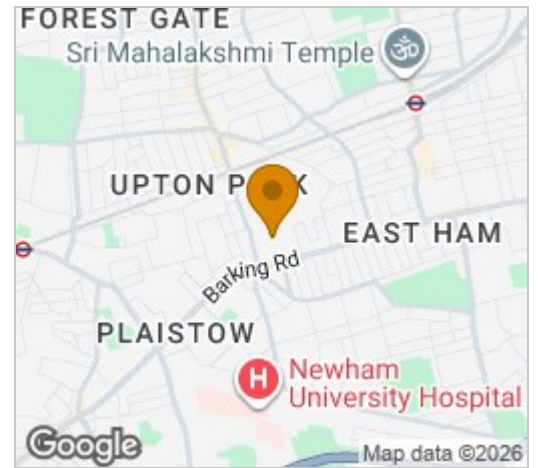

Energy Efficiency Graph

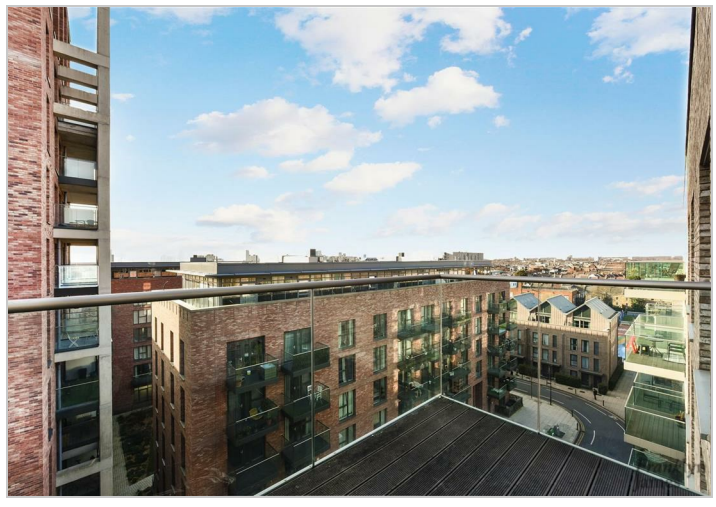
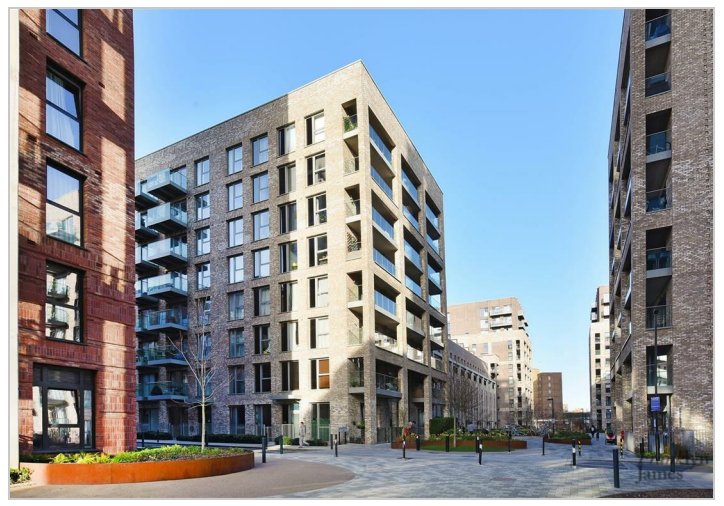
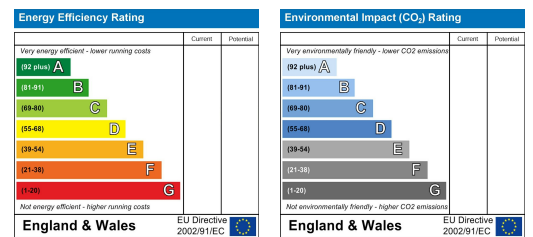

These particulars, whilst believed to be accurate are set out as a general outline only for guidance and do not constitute any part of an offer or contract. Intending purchasers should not rely on them as statements of representation of fact, but must satisfy themselves by inspection or otherwise as to their accuracy. No person in this firm's employment has the authority to make or give any representation or warranty in respect of the property.